



TRR

AIR RECIRCULATING ASPIRATOR



Improved efficiency of light impurities separation. Minimal air consumption. Considerable saving of power consumption

Totally enclosed machine in tight sheet steel.

The machine is constantly maintained under negative pressure by the incorporated impellers for suction of light impurities in a closed air recirculating system.

Axial type impellers, keyed onto a dynamically balanced rotor controlled by a belt driven motor.

Micrometric regulating valves and adjustable air channel cross section allowing easy control of air flow. Ample sight glass for convenient viewing of performance.

Inlet feeding group, mounted on vibrating pads and driven by two vibro-motors.

A uniform product distribution guarantees the perfect functionality.

Air chamber provided with a screw conveyor for discharge of dust and light impurities.

Technical information

Model	Dimensions [mm]					Weight [kg]
	A	B	D	E	F	
TRR 07A	750	1060	780	1130	1220	480
TRR 07B						380
TRR 12A	1250	1560	965	1630	1720	680
TRR 12B						600
TRR 15A	1500	1810	1000	1880	1970	800
TRR 15B						700

Model	Maximum capacity [kg/h]		Power [kW]						Exhaust [m ³ /min]	Shipping volume [m ³]	
	Wheat *		Ma ize	Driving motor of the impeller		Gearmotor		Vibrating motors			
				50 Hz	60 Hz	50 Hz	60 Hz	50 Hz			60 Hz
	Cleaning	Pre - cleaning									
TRR 07 A	9000		7200	3	3,45	0,37	0,37 / 0,43	2 x 0,27 kW	2 x 0,32 kW	8,5	4
TRR 07 B	9000	35000	-					-	-		-
TRR 12 A	16000		12800	4	4,6			2 x 0,27 kW	2 x 0,32 kW	13,5	5,6
TRR 12 B	20000	80000	-					-	-		-
TRR 15 A	24000		19200					2 x 0,27 kW	2 x 0,32 kW	16	6,1
TRR 15 B	24000	100000	-					-	-		5,5

* Capacity referred to wheat with a moisture of maximum 13%

* Capacity referred to wheat with a moisture of maximum 13%

Technical features of the equipment can be modified without any obligation of notice. Data may be not fully in accordance with the market versions.

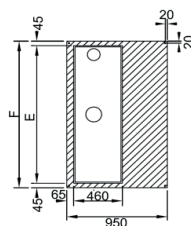
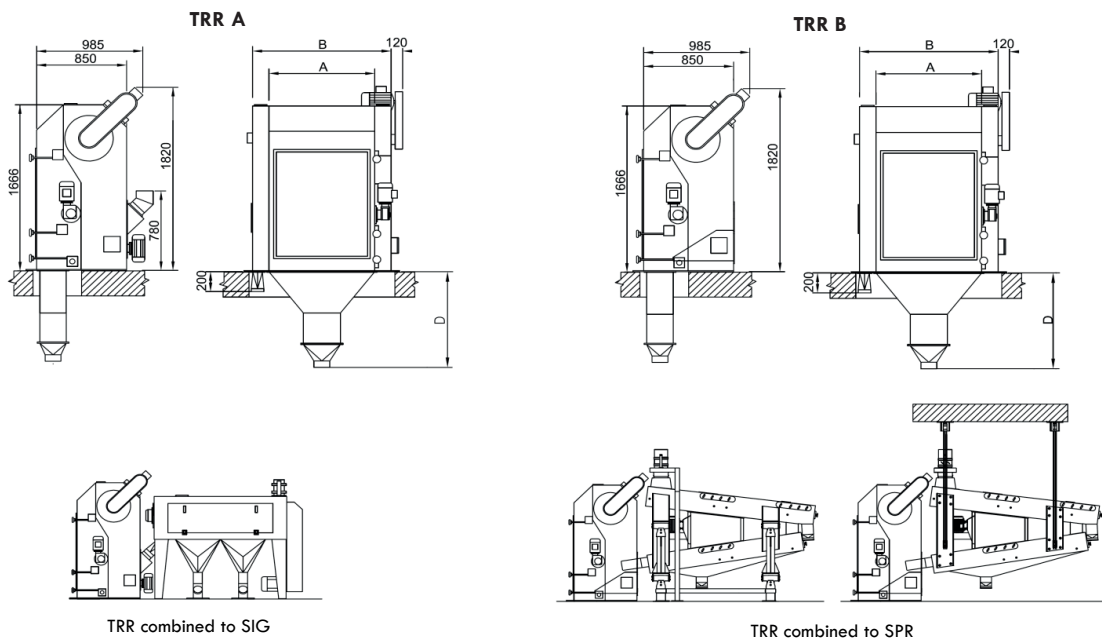



OCRIM S.p.A. - Via Massarotti, 76 - 26100 Cremona (Italy)



www.ocrim.com